

Copyright. All information furnished within this document, electronic file or design correspondence is the property of Den Hartog industries, Inc. and shall not be used, disclosed to others or copied without the expressed written consent of Den Hartog Industries, Inc.

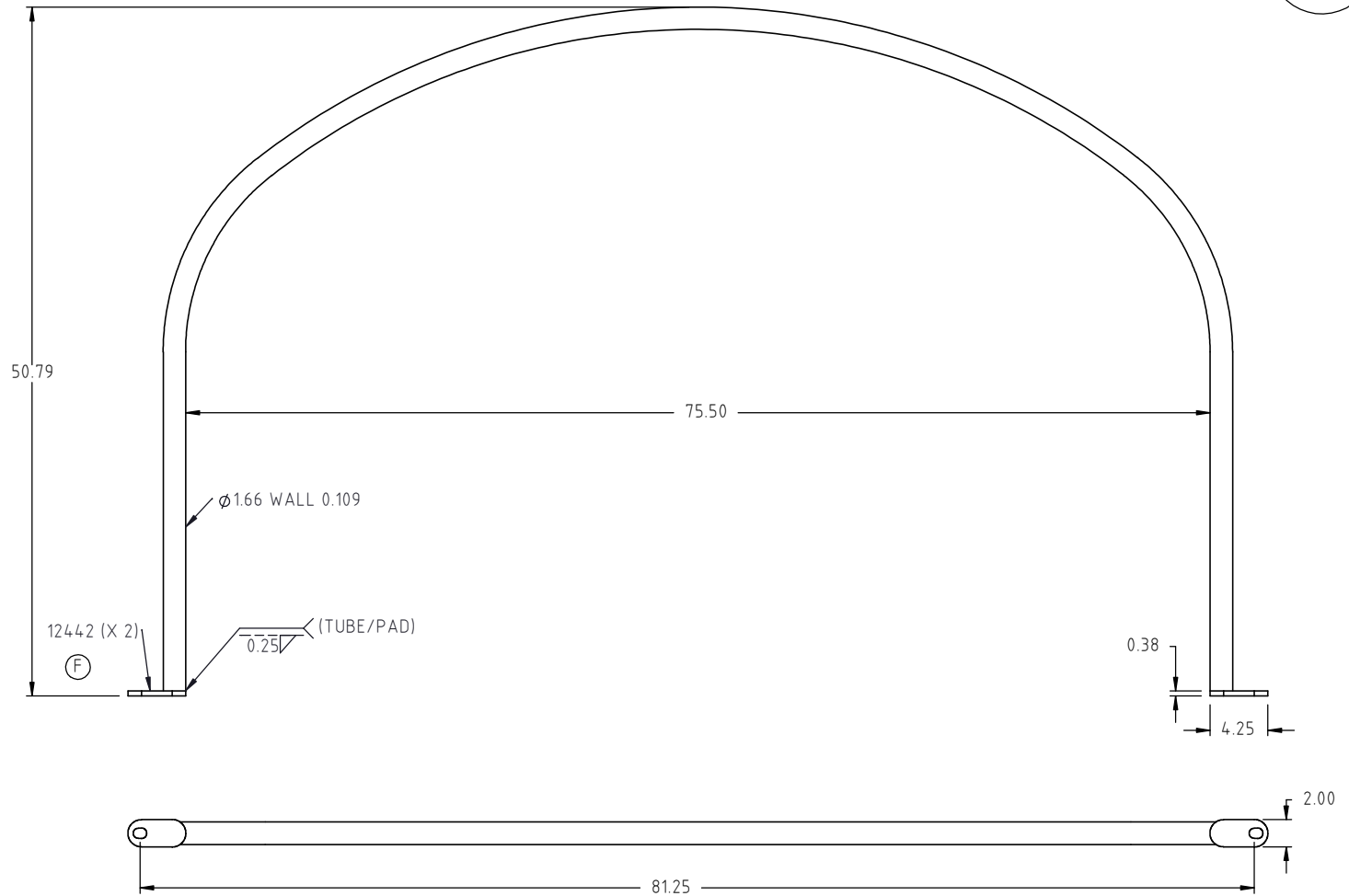

F	12442 WAS SJFS1035-HPP	ADH 7/11/12	2449
E	ADD TEXT BOX	GWC 4/2/07	
D	TOLERANCE WAS 1% @ 68°F	GWC 3/16/07	
C	ADD FOOT PART #	3/6/07	
B	ADDED WELD DESC.	NVE 6/22/06	
A	CHANGE TO POWDER COATING	12/27/04	
REV	DESCRIPTION	BY / DATE	CCN

DRAWN / DATE	MATERIAL
DHJ 1/29/03	TUBE
APPRD. / DATE	
ADH 11/9/07	



Den Hartog
INDUSTRIES, INC.

Acc Roto-Mold Injection Molding Blow Molding Sowjoy

4010 HOSPERS DRIVE S. BOX 425, HOSPERS, IOWA 51238-0425

ALL DIMENSIONS ARE IN DECIMAL INCHES
TOLERANCES UNLESS OTHERWISE SPECIFIED

POLYETHYLENE	METAL DECIMAL ± .125" FRACTION ± 1/4" ANGLE ± 1°
±1% @ 68°F	

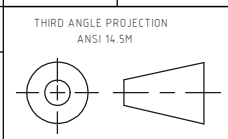

SHOT WEIGHT:	NOTES: 1.) 3 REQUIRED
SHIPPING WEIGHT:	
FINISH: POWDER COAT BLACK	

DESCRIPTION	HOOP FOR 1035 GALLON ELLIPTICAL LEG TANK	
SCALE	N.S.	PART NO. FS1035-HPS